

COMBINED SERVICES PLAN LAYOUT
SCALE 1:200

PLATFORM 01 LEVEL SETTING OUT TABLE (WGS 84 Lo 31)				
POINT	Y	X	Z	
P1.1	43 602.804	2 529 379.041	633.000	
P1.2	43 588.210	2 529 379.041	633.000	
P1.3	43 588.210	2 529 387.616	633.000	
P1.4	43 602.804	2 529 387.616	633.000	

PLATFORM 02 LEVEL SETTING OUT TABLE (WGS 84 Lo 31)				
POINT	Y	X	Z	
P2.1	43 573.133	2 529 379.081	633.000	
P2.2	43 557.928	2 529 379.042	633.000	
P2.3	43 557.929	2 529 387.616	633.000	
P2.4	43 573.133	2 529 387.616	633.000	

PLATFORM 03 LEVEL SETTING OUT TABLE (WGS 84 Lo 31)				
POINT	Y	X	Z	
P3.1	43 531.265	2 529 387.616	633.000	
P3.2	43 531.265	2 529 379.041	633.000	
P3.3	43 543.354	2 529 379.041	633.000	
P3.4	43 543.354	2 529 387.616	633.000	

BLOCK A LEVEL SETTING OUT TABLE (WGS 84 Lo 31)				
POINT	Y	X	Z	
B1.1	43 601.284	2 529 381.461	633.000	
B1.2	43 592.144	2 529 381.461	633.000	
B1.3	43 592.144	2 529 384.896	633.000	
B1.4	43 601.284	2 529 384.896	633.000	

BLOCK B LEVEL SETTING OUT TABLE (WGS 84 Lo 31)				
POINT	Y	X	Z	
B2.1	43 571.621	2 529 381.462	633.000	
B2.2	43 561.550	2 529 381.462	633.000	
B2.3	43 561.550	2 529 384.896	633.000	
B2.4	43 571.621	2 529 384.817	633.000	

BLOCK C LEVEL SETTING OUT TABLE (WGS 84 Lo 31)				
POINT	Y	X	Z	
B3.1	43 542.134	2 529 381.461	633.000	
B3.2	43 534.979	2 529 381.461	633.000	
B3.3	43 534.979	2 529 384.896	633.000	
B3.4	43 542.134	2 529 384.896	633.000	

FENCE SETTING OUT TABLE (WGS 84 Lo 31)				
POINT	Y	X	Z	
F1	43 611.345	2 529 374.018		
F2	43 499.974	2 529 374.323		
F3	43 488.134	2 529 437.693		
F4	43 502.202	2 529 441.731		
F5	43 499.870	2 529 455.457		
F6	43 597.912	2 529 466.514		

NOTE:
PLATFORMS LEVELS TO BE
CONFIRMED.

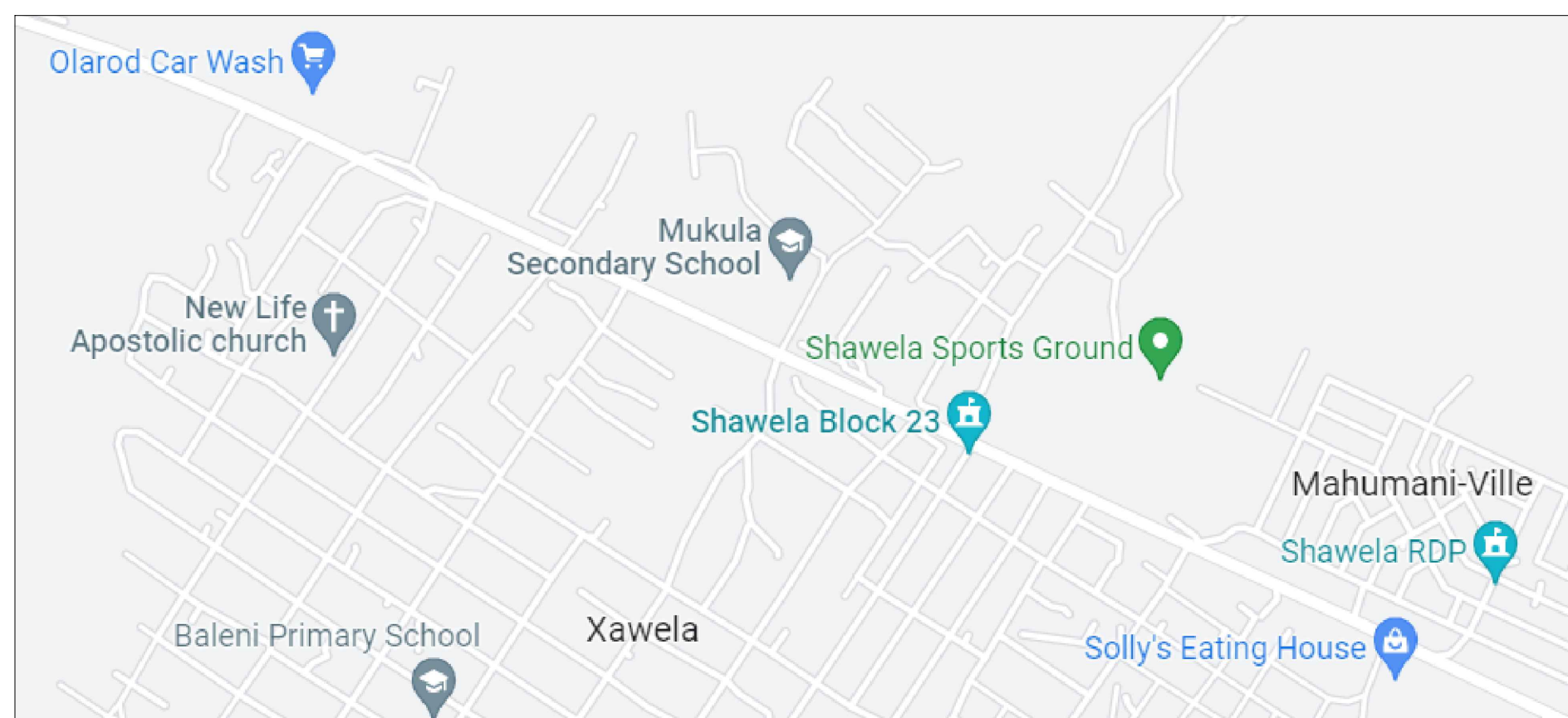

KEY PLAN
SCALE 1:200

CONTROL POINTS (WGS 84 Lo 31)				
POINT	Y	X	Z	
BM1	43 480.138	2 529 435.791	634.180	
BM2	43 469.076	2 529 363.411	631.820	

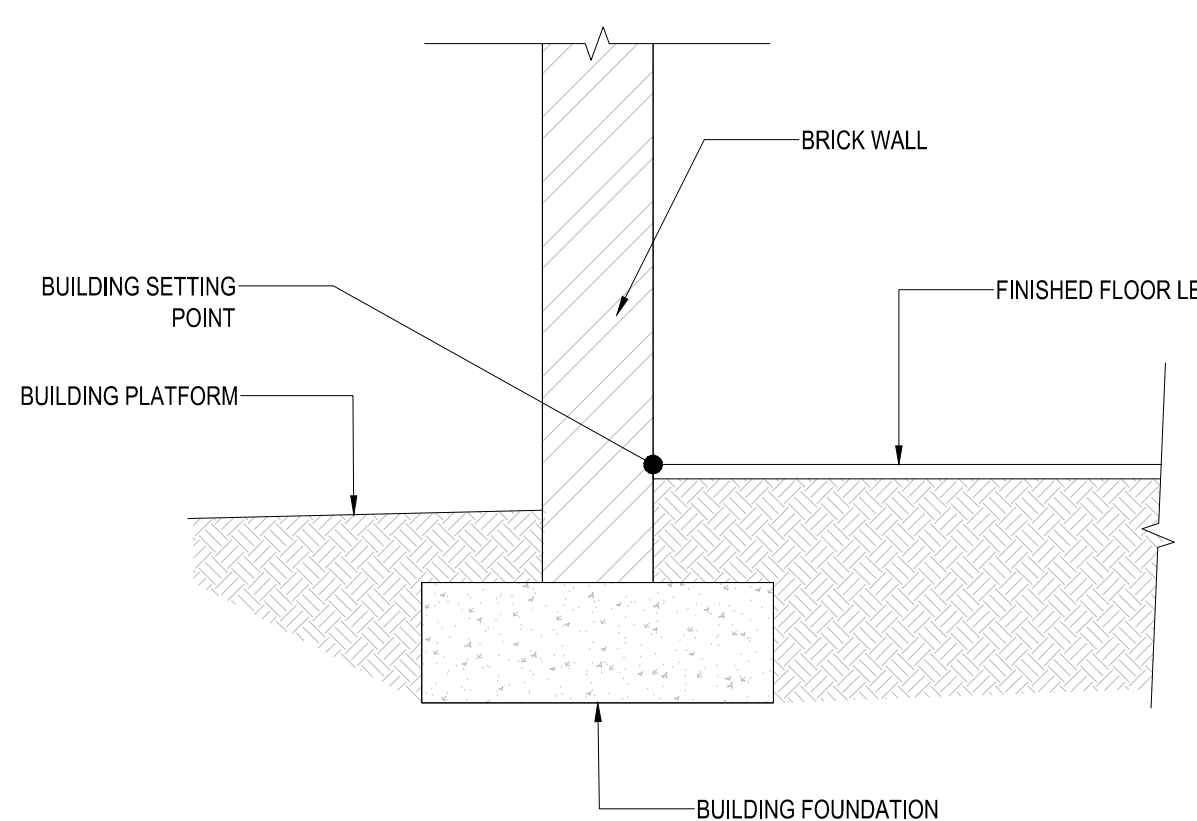

BUILDING SETTING OUT DETAILS
SCALE N.T.S.

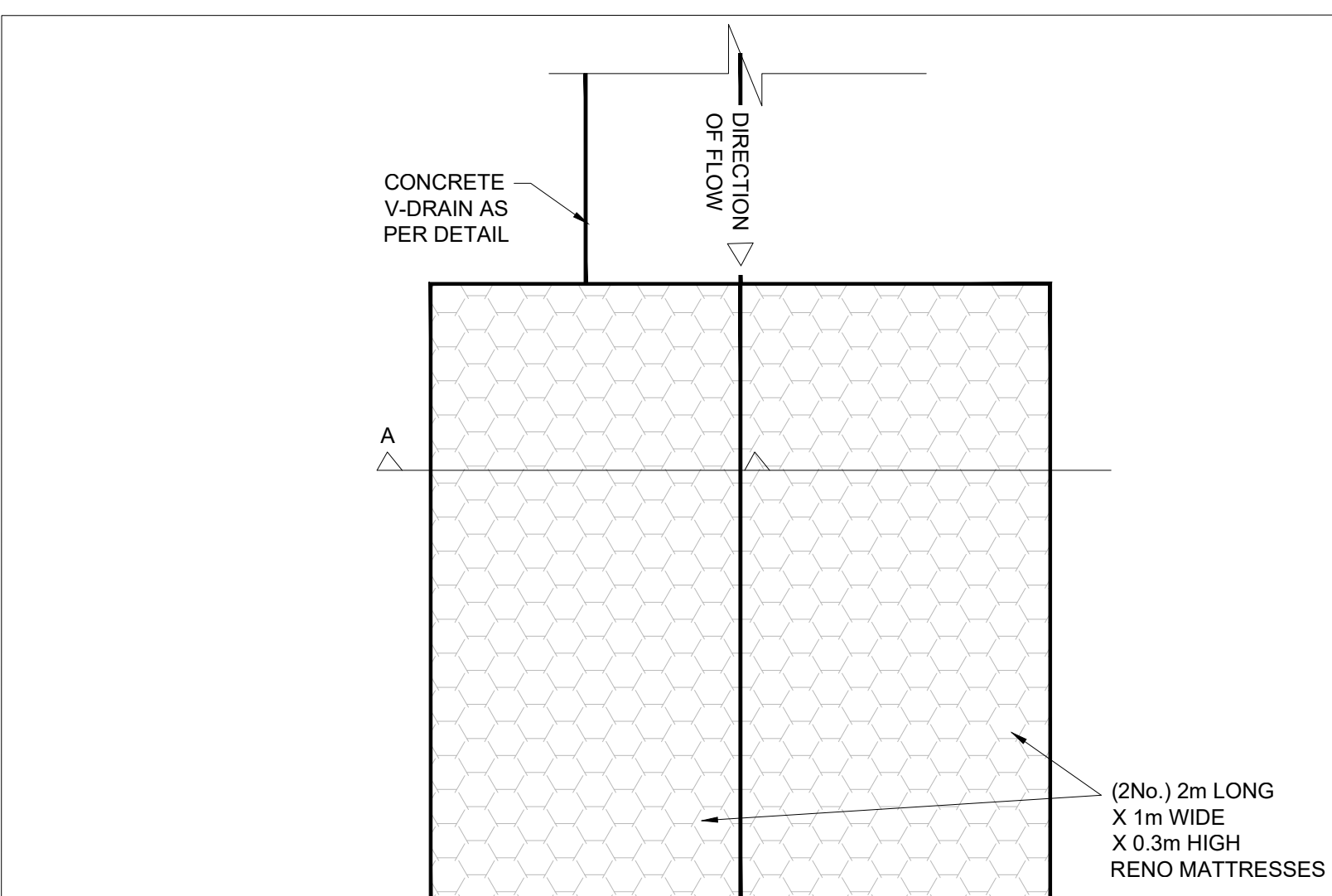

PLAN OF STORMWATER SCOUR PROTECTION
NTS

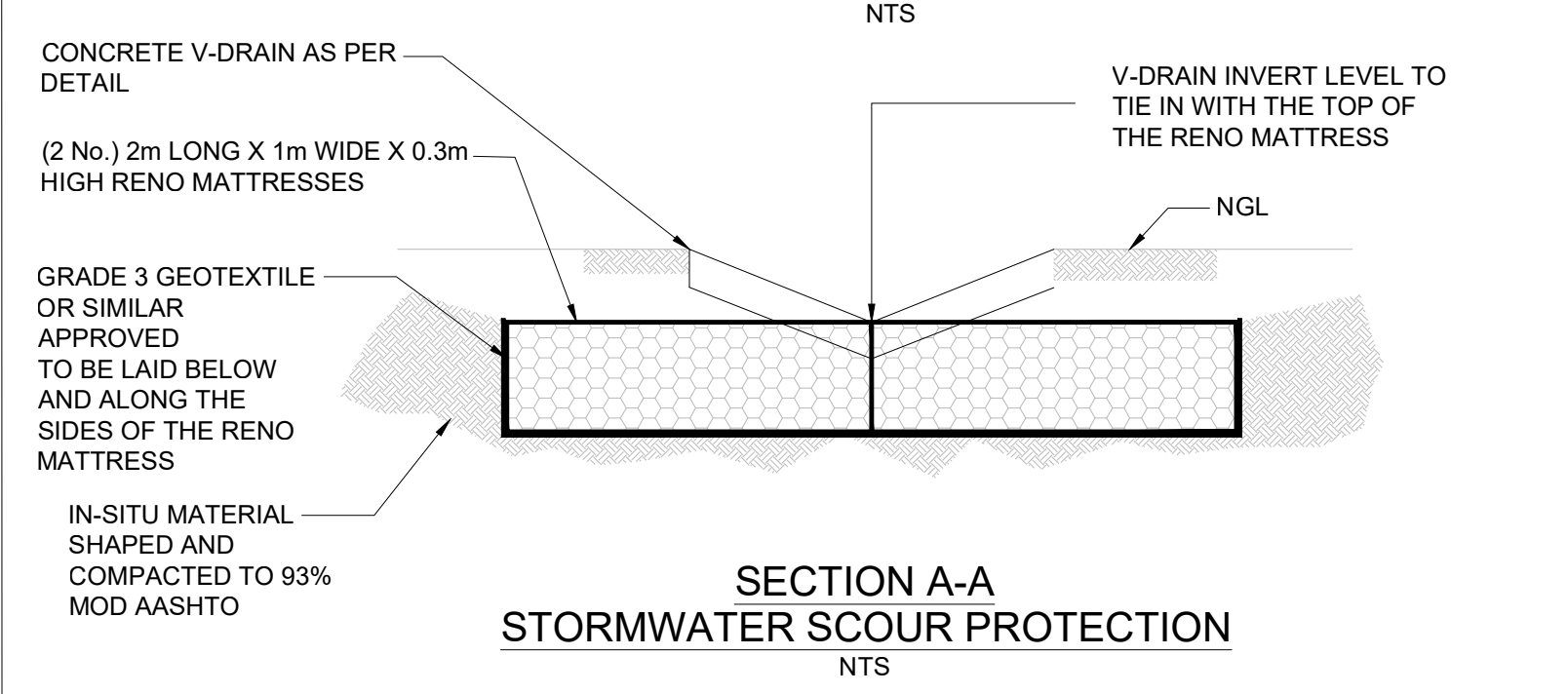

SECTION A-A
STORMWATER SCOUR PROTECTION
NTS

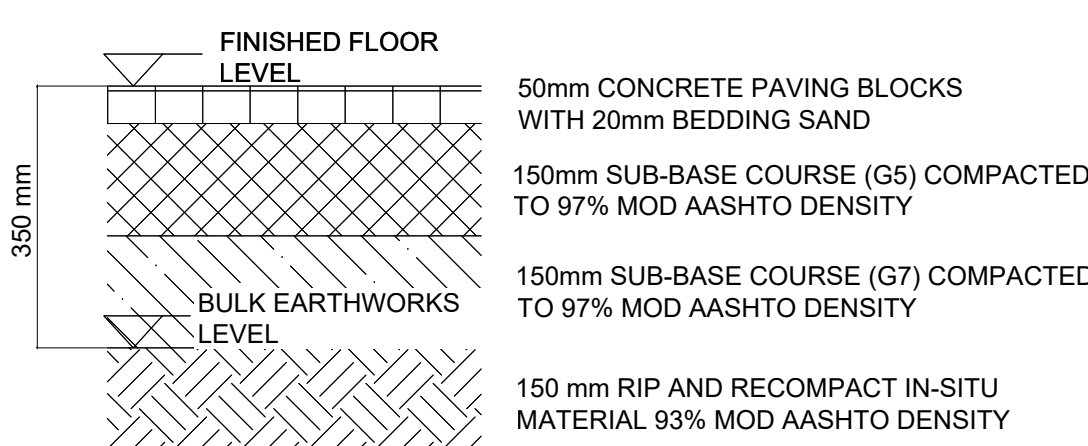

BLOCK PAVING LAYERWORKS DETAIL
SCALE 1:10

CONCRETE V-DRAIN
NTS

NOTE:
1. CONCRETE CHANNEL TO BE 100mm THICK USING 18/25 MPa CONCRETE. CONCRETE TO BE CAST IN 2m ALTERNATE PANELS WITH EXPANSION JOINTS AT 10m INTERVALS EVERY 2m PANEL.
2. CONCRETE CHANNEL TO BE REINFORCED WITH MESH REF. 193 MINIMUM COVER = 40mm

FOR TENDER

REFERENCE DRAWINGS

DRAWING NO.	DESCRIPTION

NOTES:
1. DRAWINGS ARE NOT TO BE SCALED. ALL LEVELS AND DIMENSIONS TO BE VERIFIED ON SITE PRIOR TO COMMENCEMENT OF WORKS. ANY DISCREPANCIES TO BE BROUGHT TO THE ENGINEER/ ARCHITECT'S ATTENTION IMMEDIATELY.
2. THIS DRAWING IS TO BE READ IN CONJUNCTION WITH ALL OTHER DRAWINGS, SCHEDULES AND SPECIFICATIONS RELATED TO THIS PROJECT.
3. ALL BUILDING WORK AND MATERIALS ARE TO COMPLY WITH LOCAL AUTHORITY'S REQUIREMENTS AND ARE TO BE IN ACCORDANCE WITH SANS 1040 NATIONAL BUILDING REGULATIONS AND SANS 1200.
4. THE CONTRACTOR IS RESPONSIBLE FOR PROTECTING THE WORKS FROM SURFACE WATER RUNOFF THAT MAY CAUSE EROSION DAMAGE, USING CHANNELS, BENS, PUMPS AND AS AND WHEN REQUIRED AND DIRECT GROUND WATERS AWAY FROM THE WORKS.
5. ALL CUT AND FILL BANKS ARE 1V : 2H UNLESS OTHERWISE STATED.

LEGEND

- SEWER MANHOLE
- 160mm DIAMETER SEWER PIPE
- PROPOSED SEPTIC TANK
- PROPOSED SOAKAWAY
- 1m CONCRETE V-DRAIN CHANNEL
- EXISTING BUILDING
- NEW BUILDING
- PROPOSED BLOCK PAVED WALKWAY
- PROPOSED DISABLED RAMP
- NEW FENCE REFER TO ARCHITECTURAL FOR FENCE DETAILS
- EXISTING FENCE
- ELEVATED WATER TANK
- 25mm Dia WATER PIPE
- STAND PIPE
- 50mm Dia WATER PIPE
- BOREHOLE
- FLOW DIRECTION
- RENO-MATTRESS
- 1:2 FILL EMBANKMENT
- 1:2 CUT EMBANKMENT

A	14-11-2022	SIST	FOR TENDER
NO.	DATE	INT	DESCRIPTION

ISSUE / REVISIONS			
DESIGNED	BY	DRAWN	CHECKED
	M.MKHIZE	M.MKHIZE	T.MUDAU

DRAWING CHECK			
NAME	REG NO.	SIGNATURE	DATE
T. MUDAU	PRNO.201403310		14-11-2022

PROFESSIONAL APPROVAL			
NAME	REG NO.	SIGNATURE	DATE
T. MUDAU	PRNO.201403310		14-11-2022

LIMPOPO PROVINCE
EDUCATION

THE MUKULA TRUST
A leading developmental NGO

CLIENT APPROVAL			
NAME	DIVISION	ROLE	SIGNATURE

PROJECT NAME
PROPOSED PERMANENT SANITATION FACILITIES FOR MUKULA HIGH SCHOOL

EMIS 916410676

SITE ADDRESS
LIMPOPO PROVINCE

DRAWING TITLE
COMBINED SERVICES LAYOUT PLAN

PROJECT NO.	TYPE	NUMBER	DISCIPLINE	STATUS	REV
SIST221104	LA	100	C	T	A

DISCIPLINE
CIVIL INFRASTRUCTURE

CONSORTIUM
DURBAN

22 Simso Nwanyana Goble Road,
PO BOX 111 Durban, 3600
KwaZulu-Natal, South Africa
+27 (0) 31 000 284 Tel
www.sistengineers.co.za

SIST ENGINEERS
ARCHITECTS & ENGINEERS