

NOTES:  
1. ALL AFFECTED ROAD SIGNS AND LIGHT MASTS TO BE RELOCATED TO NEW VERGE BETWEEN ROAD EDGE AND SIDEWALK EDGE  
2. NEW POSITIONS FOR ROAD SIGNS TO BE CONFIRMED ON SITE BY ENGINEER  
3. ALL AFFECTED MANHOLES TO BE LIFTED  
4. RAISED TO MATCH LEVEL OF THE NEW SIDEWALK  
5. EXISTING PAVING BLOCKS ON ROUTE OF NEW NMT FACILITY TO BE REMOVED AND STORED TO CLIENTS PREFERENCE / INSTRUCTION

LEGEND

- NEW ON-ROAD (SYMBOL ONLY) CYCLE ROUTE
- NEW CYCLE PATH
- NEW PAVED WALKWAY
- EXISTING PAVED CYCLE PATH
- EXISTING PAVED WALKWAY

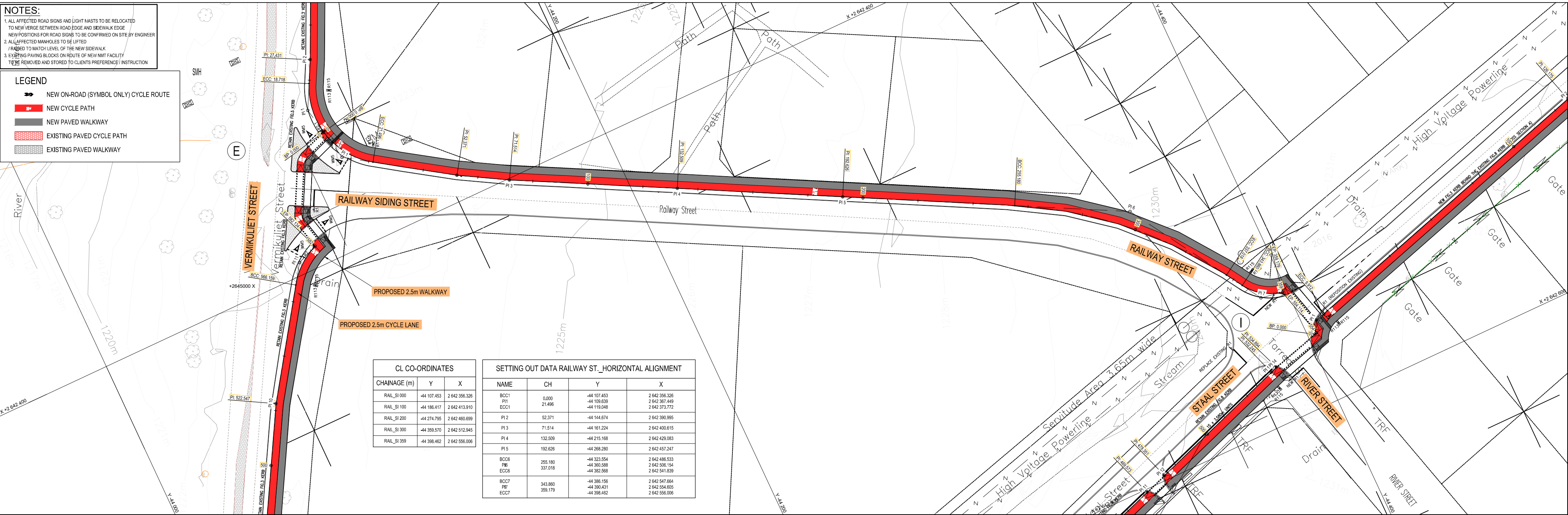

CL CO-ORDINATES			
CHAINAGE (m)	Y	X	
RAIL_SI 000	-44 107.453	2 642 356.326	
RAIL_SI 100	-44 186.417	2 642 413.910	
RAIL_SI 200	-44 274.795	2 642 480.699	
RAIL_SI 300	-44 359.570	2 642 512.945	
RAIL_SI 399	-44 396.462	2 642 556.006	

SETTING OUT DATA RAILWAY ST._HORIZONTAL ALIGNMENT			
NAME	CH	Y	X
BCC1	0.000	-44 107.453	2 642 356.326
PI1	21.846	-44 109.830	2 642 367.449
ECC1		-44 119.048	2 642 373.772
PI 2	52.371	-44 144.674	2 642 390.995
PI 3	71.514	-44 161.224	2 642 400.615
PI 4	132.359	-44 215.169	2 642 429.983
PI 5	192.626	-44 268.280	2 642 457.247
BCC6	255.180	-44 323.554	2 642 486.533
PI6	337.016	-44 360.589	2 642 506.154
ECC6		-44 382.568	2 642 541.839
BCC7	343.880	-44 386.156	2 642 547.664
PI7	399.170	-44 390.431	2 642 554.805
ECC7		-44 396.462	2 642 556.006

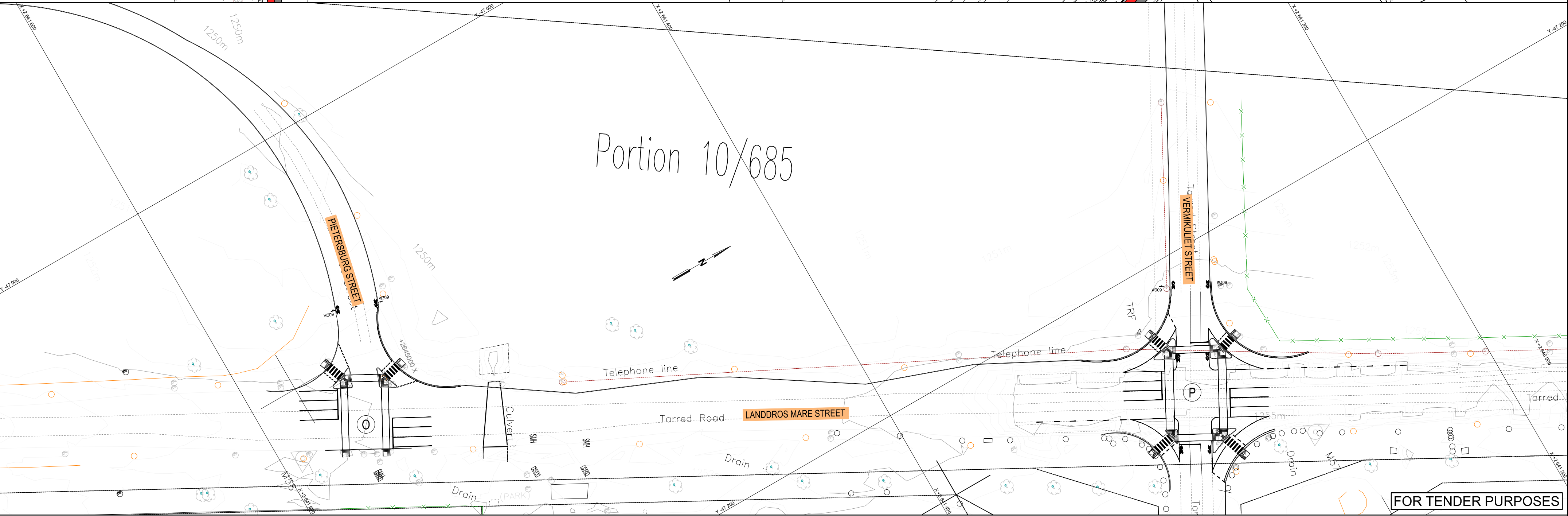

DESIGNED A. SAMPSON	CHECKED J. GELDENHUIS	APPROVED PROJ. PRINCIPAL: SIGNATURE: DATE:	ROYAL HASKONINGDHV Enhancing Society Together P.O. Box 25302 Monument Park Ext 2 0105 Tel: (012) 367 5800 Fax: (012) 367 5890 Email: pretoria@rhdhv.com	CITY OF Pretoria NATURALLY PROGRESSIVE	Technical Services P.O. Box 111, Polokwane, 0700 Civic Centre, Chr Landros Mare & Bodereau Street Polokwane, 0999, South Africa Tel: 015 290 2098 Cell: 083 382 2434 Email: polok@polokwane.gov.za	PROJECT/DRAWING TITLE POLOKWANE NON-MOTORISED TRANSPORT LAYOUT AND SETTING OUT RAILWAY STREET AND LANDDROS MARE STREET	SCALE 1 : 500 CONTRACT No. PM32/2019 DRAWING No. MD4175 / POL / LP / 05	SHEET 5 OF 10 PROJECT No. MD4175 REV A
------------------------	--------------------------	---	--	--	--	---	--	---