

GROUND STOREY PLAN LAYOUT

1:100

Ground Floor Plan

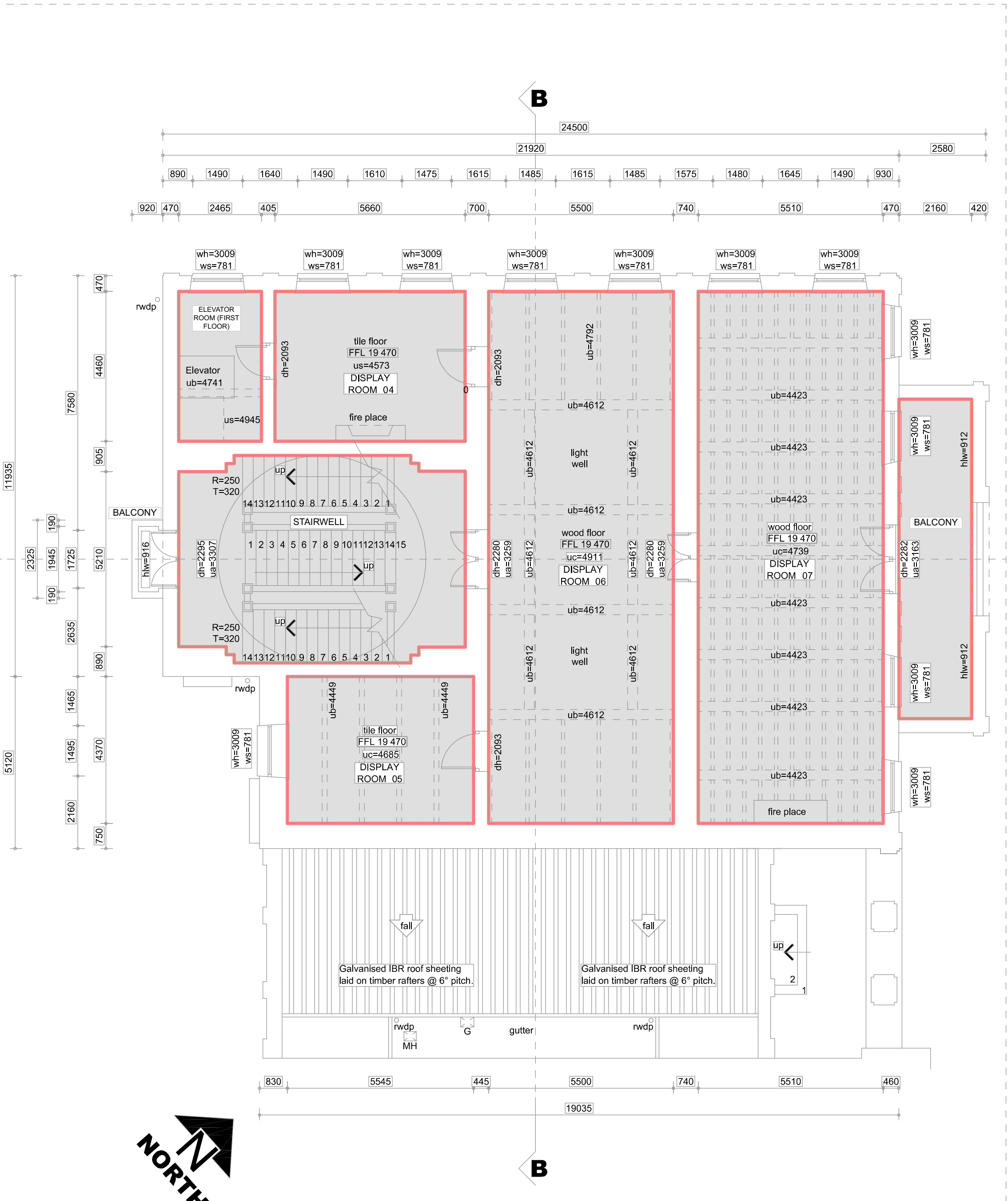

FIRST STOREY PLAN LAYOUT

1:100

First Floor Plan

BASE DRAWING SOURCE:
Drawing obtained from The Department of Public Works and Infrastructure (DPW) as part of a maintenance and repair project to the Iziko Old Town House. The drawing has been modified with the addition of OLA notes as part of an emergency RFQ project as instructed by Iziko Museums of South Africa for the repair of the building.

- NOTES:
1. THE DESIGN ON THIS DRAWING IS COPYRIGHT AND REMAINS THE PROPERTY OF THE ARCHITECT.
 2. ALL WORK IS TO BE CARRIED OUT IN ACCORDANCE WITH THE N.B.R. SANS 10400 AND LOCAL AUTHORITY REGULATIONS
 3. THE DRAWING IS NOT TO BE SCALED
 4. ANY DISCREPANCIES ARE TO BE IMMEDIATELY REPORTED TO THE ARCHITECT
 5. ALL DIMENSIONS AND LEVELS ARE TO BE CHECKED ON SITE PRIOR TO CONSTRUCTION.
 6. ALL INTERNAL AND EXTERNAL POWDER COATING TO BE IN COMPLIANCE TO QUALICOAT® CLASS 3 OR SANS 1786 AND 1578. RAL 7037 Dusty Grey. 30 YEARS, APPLIED BY AN APPOINTED APPROVED APPLICATOR. FOR COATING APPLICATION.
 7. ALL FINISHES TO BE CONFIRMED.

RevID	CHD	Change Description	Date	Issd

Owner:

Date:

Architect:

Date:

Engineer

Date:

Osmond Lange Architects and Planners (Pty) Ltd

Postal: PO Box 498, Bellville, 7535
Address: Tyger Terrace II, DJ Wood Way, Bellville, Capetown
E-mail: info@osmondlange.co.za
Tel: +27 (0) 21 948 2563 / 1877
Fax: +27 (0) 21 948 3655

PROJECT:
ISAM 2025: Foyer and Bathroom upgrade
Changes and additions to existing foyer and bathrooms
FOR #Client Full Name
ON ERF: ####
#Site Address 1, #Site City

DRAWING TITLE:
Internal Repairs: Ground and First Floor Plan

BUILDING CLASSIFICATION		CLIMATIC ZONE	
####		####	
	RESPONSIBLE PERSON	DATE	APPROVED
DESIGN	DPW, BL, JDV	2024/09/11	
DRAWN	DPW, BL		

FOR INFORMATION

DRAWING PATH /Users/Laurel/Library/CloudStorage/OneDrive-OLA/Iziko/Iziko Old Town House/IOTH Emergency RFQ.pln	SHEET SIZE A1
SCALE 1:100	PROJECT No. 220233
	DRAWING NUMBER 03
	REVISION