

| BENCH MARKS | | | |
|-------------|----------|-----------|---------|
| NAME | Y | X | Z |
| BS1 | -275.785 | 26471.064 | 126.070 |
| BS2 | -277.628 | 26468.242 | 124.338 |
| BS3 | -268.631 | 26463.238 | 124.237 |

| LEARNERS | | | | EDUCATORS | | | |
|----------|------|-------|-------|-----------|--------|-------|--|
| YEAR | BOYS | GIRLS | TOTAL | MALE | FEMALE | TOTAL | |
| 2020 | 179 | 164 | 343 | 7 | 6 | 13 | |
| 2021 | 188 | 172 | 360 | 5 | 6 | 11 | |
| 2022 | 214 | 187 | 381 | 5 | 7 | 12 | |

SCHOOL INFORMATION

| | |
|--|---|
| SCHOOL NAME | SEIPONE SENIOR SECONDARY SCHOOL |
| GRAND NUMBER | 02227-017 |
| MUNICIPAL DISTRICT | CAPRICORN NORTH |
| SCHOOL LOCATION | LOCATION: E 28° 31' N LATITUDE: 28° 31' N |
| TOTAL NUMBER OF LEARNERS ENROLLED 2022 | 381 |
| TOTAL NUMBER OF EDUCATORS 2022 | 12 |

LEGEND

| | |
|-----------------------------|-----------------|
| FENCE | —X—X—X— |
| CONCRETE | — |
| TELEPHONE LINE | —o—o—o—o—o—o—o— |
| WATER PIPELINE | —w—w—w—w—w—w—w— |
| BENCH MARK | ▲ |
| WATER VALVE CHAMBER | o |
| SCHOOL BOARD | o |
| ROAD SIGN | o |
| EXISTING BUILDING BLOCK | hatched |
| PROPOSED NEW BUILDING BLOCK | hatched |

SCHEDULE INDICATING DEMOLITION AREAS

| |
|--|
| 1 X 10 PIT TOILET SEATS TO BE DEMOLISHED IN THIS SCHOOL |
| 1 X 14 ENVIROLOO TOILET SEATS TO BE REFURISHED/RENOVATED |



| SEIPONE SECONDARY SCHOOL | | | | | |
|--------------------------|--------------|---------------------|-----------------|------------------|--------------------|
| BLOCK NUMBER | EXISTING/NEW | STAFF/GR BOYS/GIRLS | NUMBER OF SEATS | NUMBER OF URNALS | NUMBER OF DISABLED |
| 1 | EXISTING | GIRLS | 4 | 0 | 0 |
| 1 | EXISTING | BOYS | 2 | 4 | 0 |
| 1 | EXISTING | BOYS & GIRLS | 4 | 0 | 0 |
| 1 | NEW | STAFF (SDS + 2D/A) | 6 (3M, 3F) | 4 | 2 |
| 1 | NEW | BOYS (M1 + D/A) | 1 | 2 | 1 |
| 1 | NEW | GIRLS (F2 + D/A) | 2 | 0 | 1 |

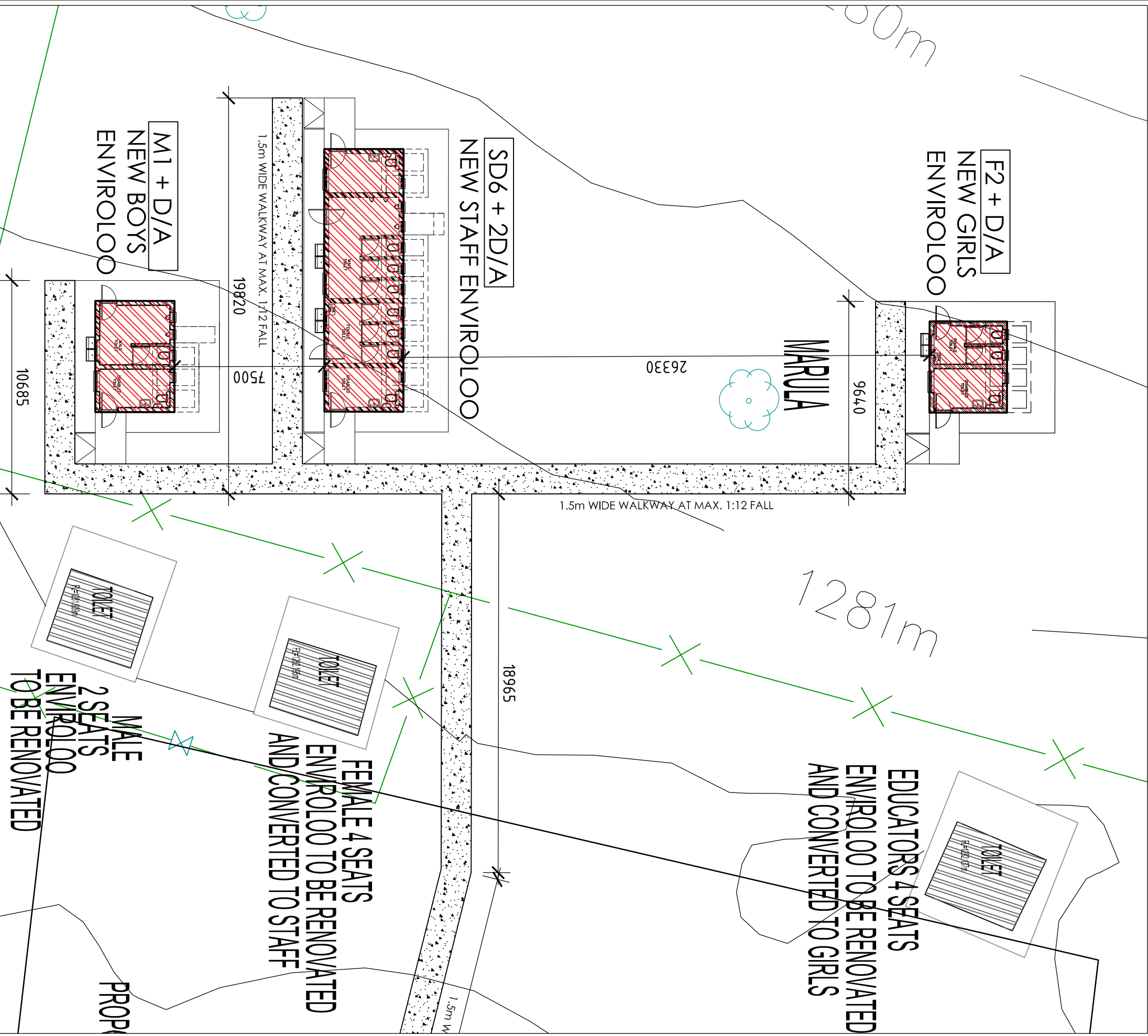

SDP DEVELOPMENT BLOW-UP LAYOUT
Scale 1:200

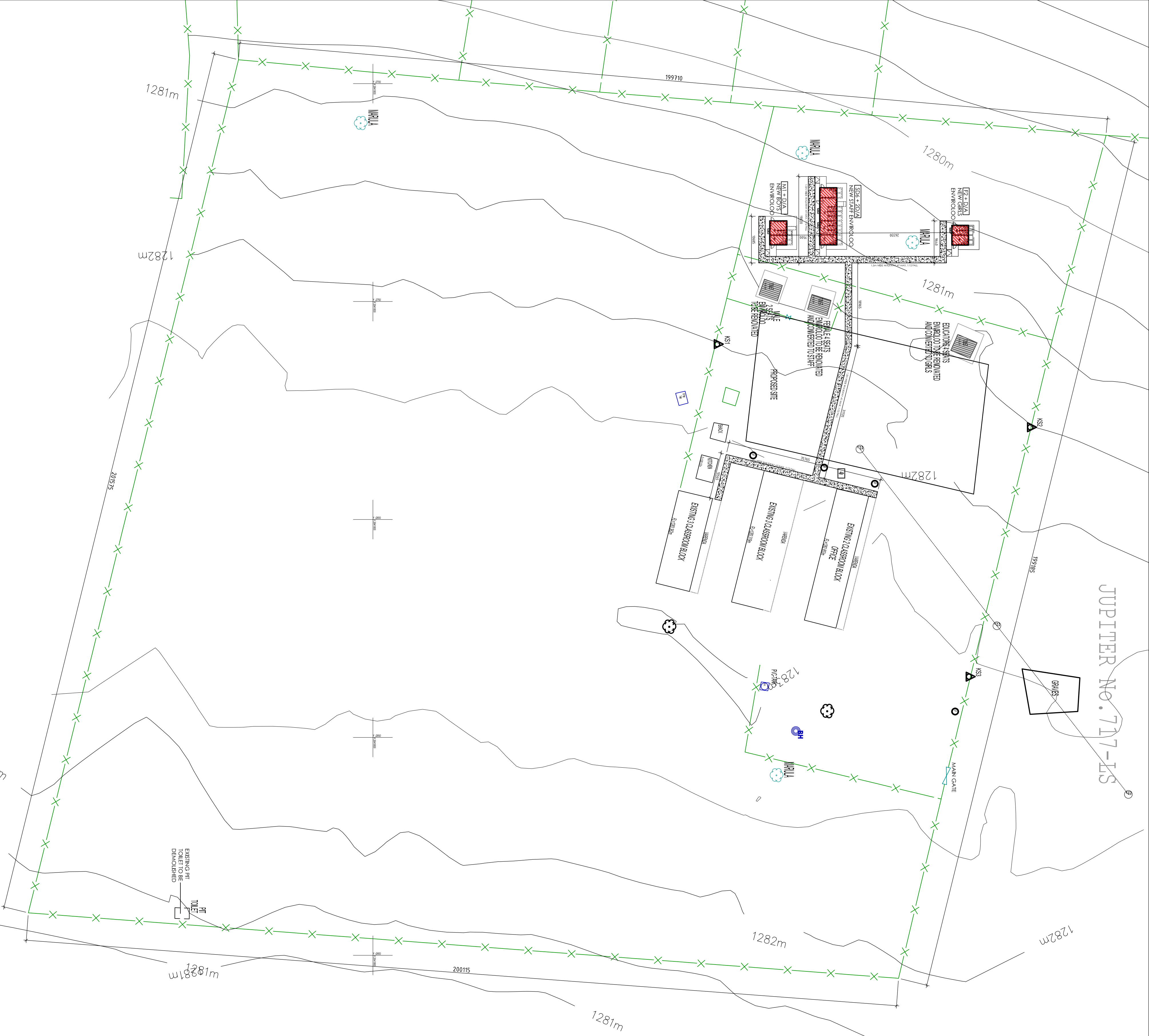

SDP SITE DEVELOPMENT PLAN
Scale 1:1000

GENERAL NOTES:

- * ALL DIMENSIONS AND LEVELS ARE TO BE VERIFIED ON SITE PRIOR TO COMMENCING SETTING OUT. WORKSHOP DRAWINGS OR CONSTRUCTION.
- * FIGURED DIMENSIONS ONLY TO BE USED.
- * DISCREPANCIES, ERRORS AND OMISSIONS ARE TO BE REPORTED TO ARCHITECTS IMMEDIATELY THEY BECOME EVIDENT.
- * SHOP DRAWINGS TO BE SUBMITTED FOR APPROVAL PRIOR TO MANUFACTURE OR INSTALLATION.
- * COPYRIGHT AND RIGHT OF REPRODUCTION OF THIS DRAWINGS OR ANY PORTION THEREOF IS RESERVED MVA ARCHITECTS.

Revisions During Construction

| Rev # | Issued Date | Revision description | Sign |
|-------|-------------|------------------------|------|
| A | 03.10.2022 | Change in seat numbers | Sign |
| B | 07.11.2022 | Change in abutment | Sign |

| Issued For | Information | Client Approval |
|----------------|----------------|-----------------|
| Information | Information | Information |
| Measurement | Measurement | Measurement |
| Detail Symbols | Detail Symbols | Detail Symbols |



Client: Kruger Office Park, Unit 6
Pretoria, 0001
Tel: 015 291 1005 | Fax: 086 560 4404
www.mvula.co.za

A leading development NGO
THE MVULA TRUST
Client project number: CLUSTER 04

Project Title: PROPOSED NEW WATER, SANITATION AND FENCING FOR THE MVULA TRUST
Site information: SEIPONE SENIOR SECONDARY SCHOOL, JUPITER VILLAGE
EMIS NO.: 922221470

Project Architect: Project Co-ordinator/Manager: Project Architectural Technician: Drawing Title: SITE DEVELOPMENT PLAN

| Project number: | Drawing number: | Project Stage: | Drawing Revision: |
|-----------------|-----------------|----------------|-------------------|
| SDP | Const | B | |
| AS SHOWN | TM | RM | |
| 2022/06/30 | 2022/11/07 | | |