

NOTE:

PIPE SIZE	BYPASS SIZE
300 <	NO BYPASS
300 ≤ 600	1000
> 600	1500

PIPEWORK DETAIL		
NO.	DESCRIPTION	QUANT.
1	100mm Ø STUB (CUT TO SUIT) F.O.E.	2
2	100mm Ø DIA x 90° SHORT RADIUS BEND F.O.E.	2
3	100mm Ø SPOOL PIECE (CUT TO SUIT) F.O.E.	2
4	100mm Ø WIDE x 4.5mm PLATE COLLAR	2
5	100mm Ø CLASS 16/25 WAFER VALVE	1
ALL FLANGE TO SABS 1123 PN RATING TO MATCH THAT OF PIPE		

- NOTES:
- COVER TO ALL REINFORCING STEEL: ROOF SLAB - 30mm FLOOR SLAB - 50mm
 - CONCRETE GRADE TO BE 25/19.
 - LIFTING HOLES TO BE SEALED WITH BITUMINOUS JOINT SEALER (ABE - BITUJOINT (PUTTY) OR SIMILAR APPROVED).
 - ROOF SLAB TO BE PRECAST ON SHUTTERS.
 - CHAMBER TO BE FOUNDED ON IN-SITU MATERIAL OR ON REWORKED MATERIAL COMPACTED TO 95% Mod. A.A.S.H.T.O.
 - ALL EXPOSED CONCRETE EDGES TO HAVE 20mm x 20mm CHAMFERS.
 - FOUNDATIONS TO HAVE 50mm THICK BLINDING LAYER OF GRADE 15/25 CONCRETE BEFORE BASE REINFORCEMENT IS PLACED.
 - EXPOSED SURFACES OF CHAMBER AND ROOF SLABS TO BE PAINTED WITH 2 COATS OF PAINT, "IVORY PROTECTOCOTE" OR SIMILAR APPROVED. COLOR: EXPOSED VERTICAL SURFACES OF CHAMBER & ROOF SLAB - FOREST GREEN. (SABS 1091, TABLE 1, GROUP H09). EXPOSED HORIZONTAL SURFACE OF ROOF SLAB - GOLDEN YELLOW. (SABS 1091, TABLE 1, GROUP B49).
 - INTERNAL BRICKWORK JOINTS TO BE POINTED. NO PAINTING REQUIRED.
 - ALL PIPEWORK TO BE LIGHTLY ABRASSED AND PAINTED WITH ONE COAT OF UNIVERSAL UNDERCOAT AND 2 COATS OF "CORNFLOWER BLUE" ENAMEL PAINT. (SABS 1091, TABLE 1, GROUP F29).
 - BUTTERFLY VALVE TO BE PAINTED WITH ONE COAT OF UNIVERSAL UNDERCOAT AND 2 COATS OF "CANARY YELLOW" ENAMEL PAINT. (SABS 1091, TABLE 1, GROUP C61).
 - BRICKWORK TO BE REINFORCED WITH BRICKFORCE EVERY SECOND COURSE. OUTER FACE OF BRICKWORK AND SIDE OF CONCRETE FLOOR SLAB TO BE PAINTED WITH 2 COATS OF "EVERBOND" OR SIMILAR APPROVED SEALING COMPOUND.
 - BRICKWORK: BRICK TYPE - NFX (NON FACING EXTRA) MORTAR - 1:3 BRICK MASONRY BOND - ENGLISH BOND
 - ELECTRICAL CONTINUITY BONDING TO BE PROVIDED AROUND NON-RETURN VALVE.
 - AIR VENT ASSEMBLIES TO BE HOT-DIP GALVANISED AND PAINTED WITH 2 COATS OF IVORY PROTECTOCOTE OR SIMILAR APPROVED. COLOR: GOLDEN YELLOW.
 - PIPEWORK (INCLUDING MANUFACTURE OF AIR VENTS) TO BE DONE BY MAIN CONTRACTOR.
 - POSITION OF AIR VALVE (i.e. UP STREAM OR DOWN STREAM OF BV) TO BE DETERMINED ON SITE BY THE ENGINEER.
 - REFER TO SHEET 12 FOR REINFORCING DETAILS.
 - PIPE TO BE TESTED IN SECTIONS DEPENDANT ON WHERE PLATE THICKNESS.

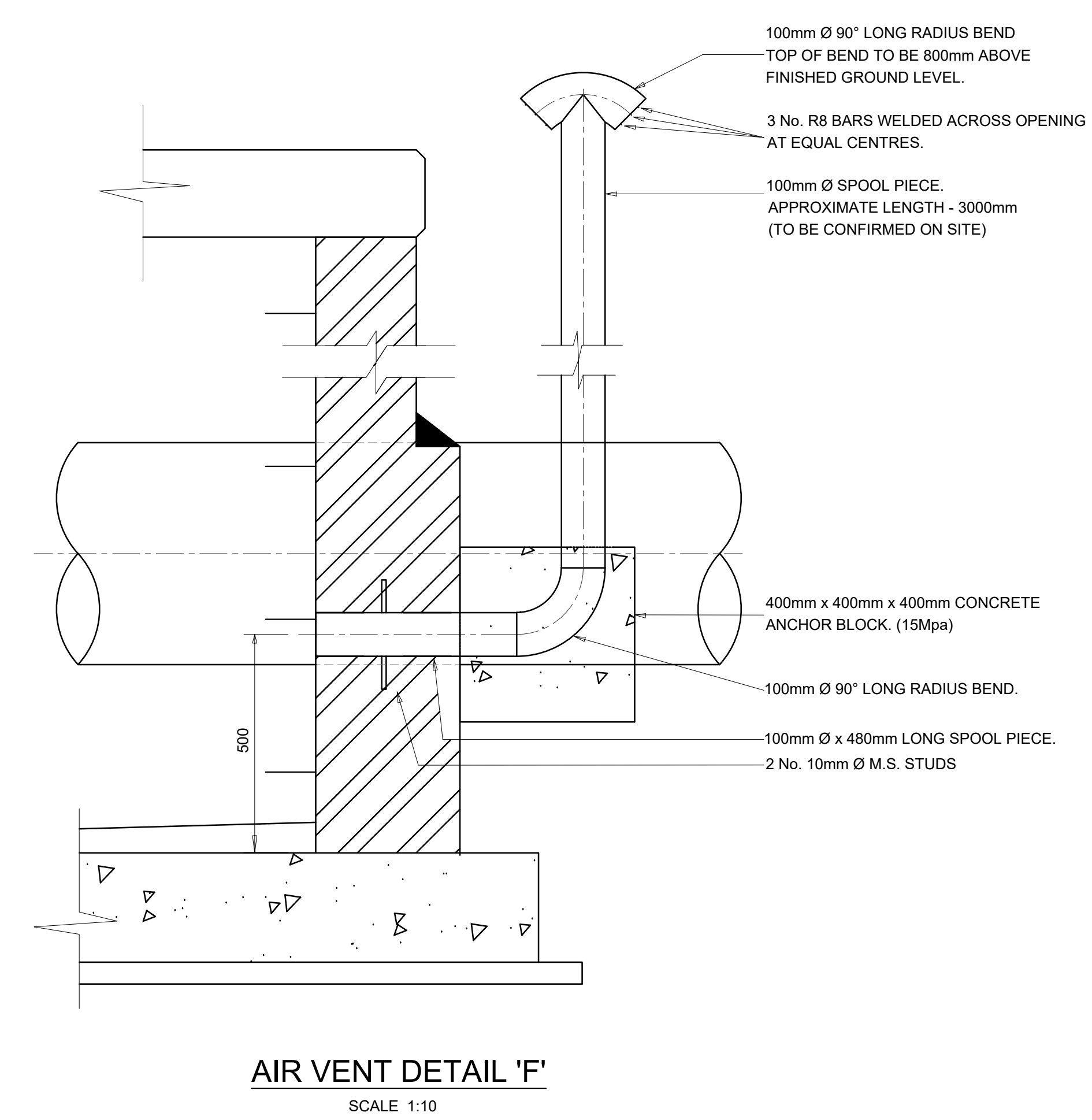
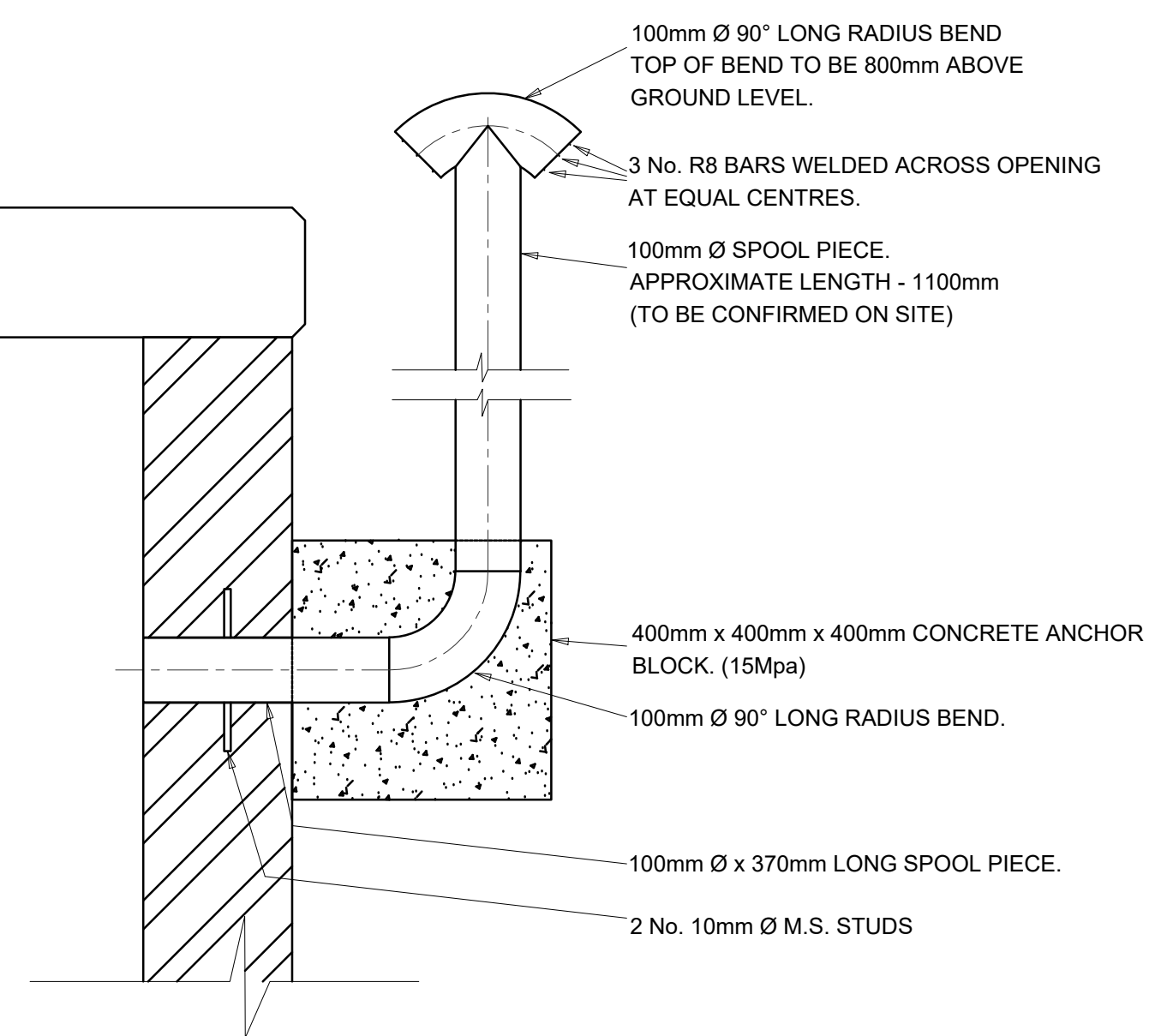
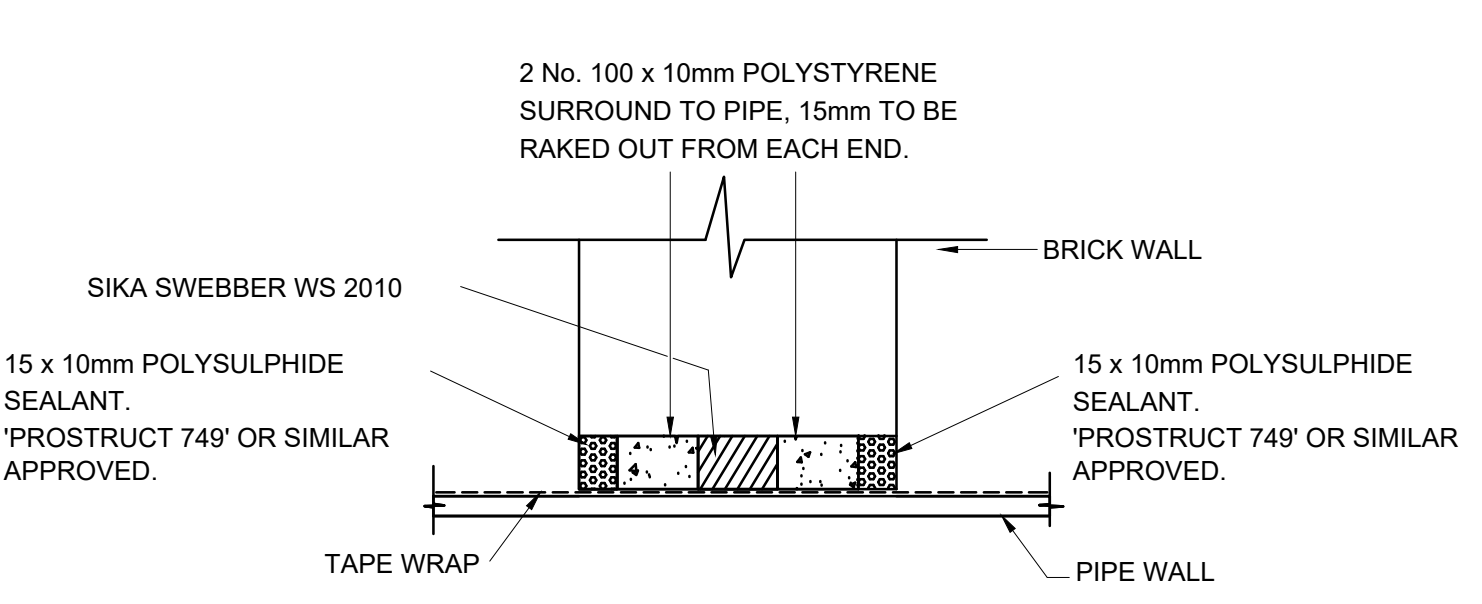

ETHEKWINI WATER AND SANITATION

WATER DESIGN BRANCH

REDUCED PLAN USE SCALE BELOW

LEGEND

EXISTING UNDERGROUND SERVICES ARE AS SHOWN BELOW.

NEW INFRASTRUCTURE

EXISTING INFRASTRUCTURE

CONSTRUCTION INFORMATION

MAINLAYER	
START DATE	
FINISH DATE	
W/O NUMBER	
LEVEL OF SERVICE	
SUPERVISOR NAME	
CONTACT NUMBER	
DATE SENT TO GIS	
GIS INFORMATION	
DATE RECEIVED	
NAME	

Revision	Date	Description
A	MAR 2023	ISSUED FOR TENDER

NOTE: No construction work to commence until land and servitude acquisitions have been completed.

Acquisitions completed:

Date	Engineer	NORTH	POINT

UNDERGROUND SERVICES CHECKED -

SERVICE	DATE	SIGNATURE
S.W.DRAWING		
SEWERS		
WATERMANS		
TELKOM CABLES		
ELECTRIC CABLES		
S.A.R. CABLES		
E.S.C. CABLES		
OIL PIPE LINE		

NOTE: Only underground services affected by new construction are shown. Care must be taken during excavations for road foundations, trenches etc. to avoid damage to underground services such as sewers, drains, cables, watermains and connections. Whenever possible these must be located before work begins.

Contract No. WS 7589

Project No. X6714

Planning Unit WEST HAMMARSDALE - STERKSPRUIT

Ward No. 103 and 4

Project Title HAMMARSDALE HIGH LEVEL RESERVOIR INLET (PHASE 2)

Drawing Title STANDARD BUTTERFLY VALVE BRICK CHAMBER WITH 100mm Ø BYPASS TYPE - 2 LAYOUT AND DETAILS (H43)

Scale: 1:20 & 1:10

Designed: R.NHUMAYO

Date: MAR 2023

Checked: S.ZULU

Drawn: S.ZULU

Area Engineer

Manager (Water Design)

Deputy Head (Engineering)

E. MSWELI - Head (W & S)

Drawing No. 56724

20/24 Sheet

Rev. A

FOR TENDER PURPOSES